

## KZS-2M A B16/0.01



### Specificatii

Cod ETI	002173214
Descriere	KZS-2M A B16/0.01
Denumire clasă	Disjunctor cu protecție diferențială (RCBO)
Curent nominal (A)	16A
Tip	A
Curent de defect nominal (A)	0.01A
Caracteristică de întrerupere	B
Număr de poli	1+N
Capacitatea de rupere (kA)	10kA
Frecvență nominală (Hz)	50Hz/60Hz
Secțiune transversală nominală	1mm <sup>2</sup> -25mm <sup>2</sup>
Standarde	IEC/EN 61009

Pagina de produse online [🔗](#)

### Alta documentatie



Catalog caracteristici tehnice

Certificate

Model 3D

2D mușchi

Manual de instrucțiuni

Declaratie CE

Eplan mușchi

## ETIM clasificare internațională

Clasificare	EC000905
Denumire clasă	Earth leakage circuit breaker
Number of poles (total)	2
Number of protected poles	1
Rated voltage	230V
Rated insulation voltage $U_i$	500V
Rated current	16A
Rated fault current	0,01A
Leakage current type	A
Current limiting class	3
Rated short-circuit breaking capacity according to EN 61009	10kA
Voltage type	AC
Frequency	50/60 Hz
Release characteristic	B
Concurrently switching neutral conductor	1
Width in number of modular spacings	2
Built-in depth	69mm
Degree of protection (IP)	IP20
Connectable conductor cross section solid-core	1...25mm <sup>2</sup>
Connectable conductor cross section multi-wired	1...25mm <sup>2</sup>

## Desen cotat

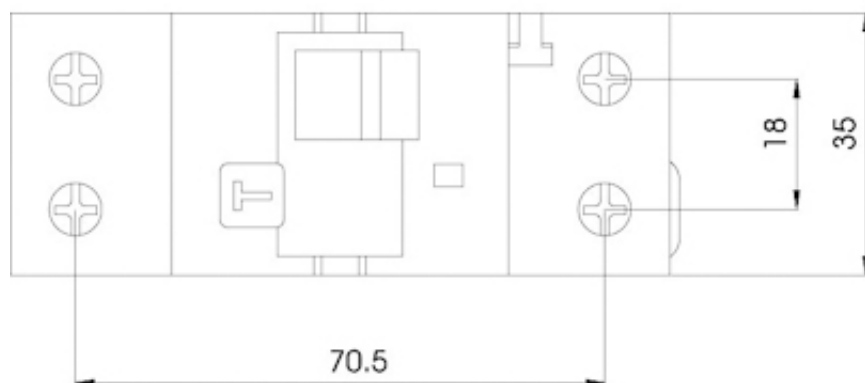
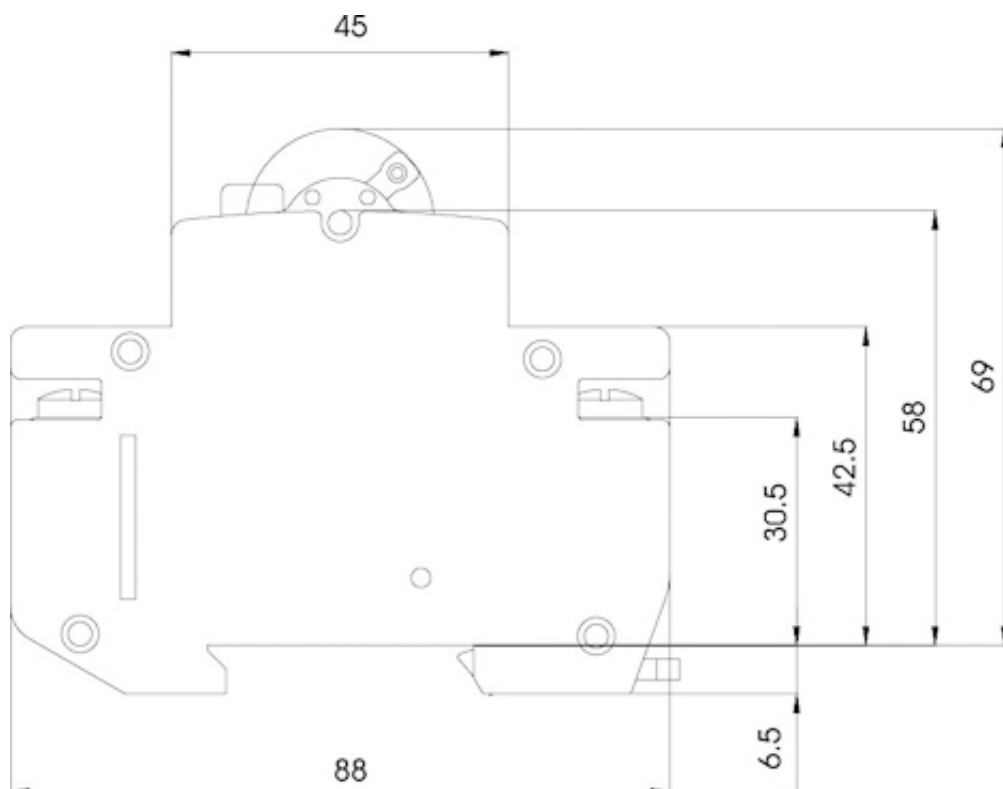

## Simbol/Conexiune

